

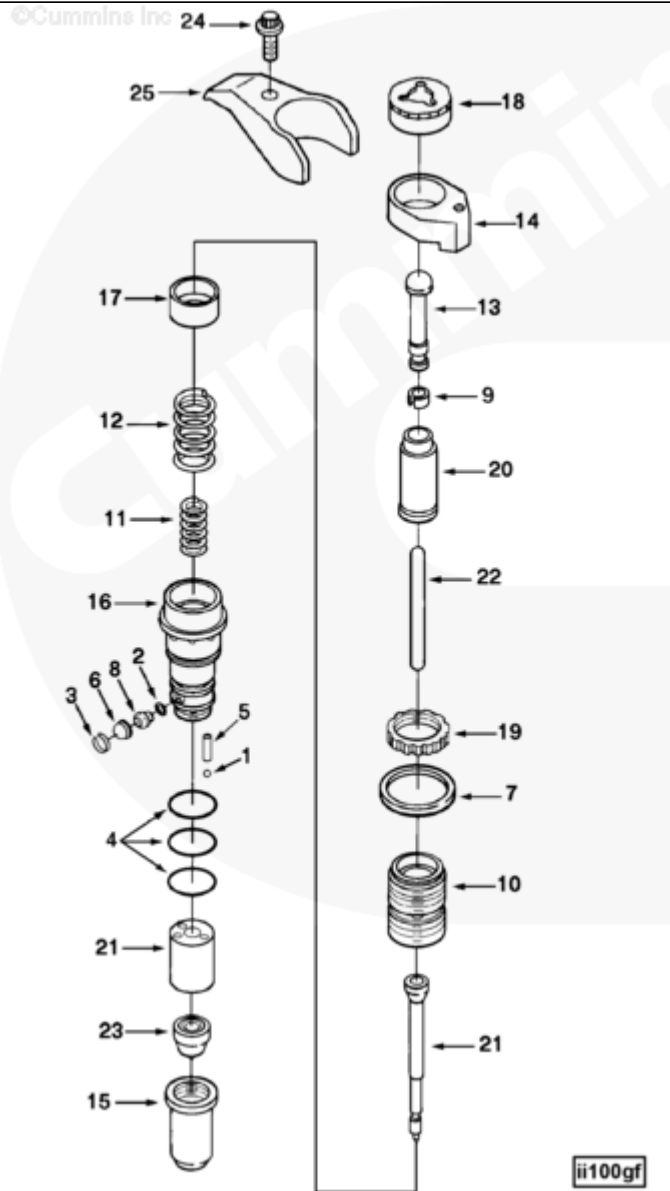

Parts Catalog - Option Detail

Electronic Parts Catalog - Option Detail				
Option	Group	Graphic	Film Card	Date
PP2862-01	06.01	ii100gf	FF	29-MAY-00
Engines	G855, G855 CM558, GTA855 CM558 (CM2358) G101, N14 CELECT, N14 CELECT PLUS, N14 MECHANICAL, NH/NT 855, QSM11 CM876 M101, QSM11 CM876 M102M, QSN14 CM876 N103, QSN14 CM876 N105, QSNT14 CM876 N102			



SMALL | MEDIUM | LARGE

Cart	Ref No	Part Number	Part Description	Required	Remarks
View My Cart					

		PP2862-01	Injector		Top-stop setting: .242"....(More)
					Total injector travel: .331"
					Calibration: 242-244
					MM3/stroke. Calibration cam:
					.248 Hartridge.
<input type="checkbox"/>		3084891	Injector		Recon equivalent 3084891 PX
<input type="checkbox"/>	1	167157	Check Ball	1	
<input type="checkbox"/>	2	173086	Injector Gasket	1	
<input type="checkbox"/>	3	174299	Screen Retainer	1	
<input type="checkbox"/>	4	193736	O-Ring Seal	3	Orange
<input type="checkbox"/>	5	203426	Roll Pin	2	
<input type="checkbox"/>	6	3054999	Filter Screen	1	
<input type="checkbox"/>	7	3041493	Plain Washer	1	1 1/2 Inch.
	8	3045047	Injector Orifice Plug	1	
<input type="checkbox"/>	9	3052231	Injector Link Retainer	1	
<input type="checkbox"/>	10	3055742	Injector Stop Screw	1	
<input type="checkbox"/>	11	3034167	Compression Spring	1	
<input type="checkbox"/>	12	3023478	Compression Spring		
<input type="checkbox"/>	13	3084896	Injector Plunger Link	1	
<input type="checkbox"/>	14	3078201	Tappet Top Stop Lock Nut	1	
<input type="checkbox"/>	15	185138	Injector Cup Retainer	1	
<input type="checkbox"/>	16	3023934	Injector Adapter	1	
<input type="checkbox"/>	17	3052218	Injector Spring Retainer	1	
<input type="checkbox"/>	18	3068859	Tappet Top Stop Cap		
<input type="checkbox"/>	19	3068860	Lock Nut	1	1 5/16 - 18 UNF.
<input type="checkbox"/>	20	3075383	Hydraulic Variable Timing Tappet	1	Recon equivalent 3075383 RX
<input type="checkbox"/>	21	3084892	Injector Barrel		
		3084894	Injector Plunger	1	
		3084893	Injector Barrel	1	
<input type="checkbox"/>	22	3062009	Injector Plunger Link		

<input type="checkbox"/>	23	3084895	Injector Cup	1	
<input type="checkbox"/>	24	205278	Twelve Point Cap Screw	1	3/8 - 16 X 3 Inch.
<input type="checkbox"/>	25	3067992	Injector Clamp	1	

© 2019 Cummins Inc., Box 3005, Columbus, IN 47202-3005 U.S.A.
Terms of Use and Disclaimers | Recommended System Requirements
Need Assistance? Please click on the Contact Us button in the top right corner of any page.